

# FREEFORM LDSISP01.9FF

FLEXIBLE INDOOR AND OUTDOOR LED SCREENS  
FOR CURVED AND IRREGULAR SHAPED  
PROJECTS



- Suitable for any kind of convex or concave installations
- Intelligent construction for ultra-thin frame depth
- Lightweight for easy adaptation and low cost framework design
- Improved mask structure that increases viewing angle
- Special framework design and production available

## QATAR AIRPORT DOHA / QATAR



### General

Operating environment	indoor
Pixel pitch	1.9mm
Service type	front and rear access
Calibrated brightness (nits)	700nits
Lamp type	SMD
Lifespan (hours at %50 brightness)	>100.000hours
White color calibration (adj.)	3.500K~8.500K
Gray scale	>16bits
Brightness control	256 level

### Module Specifications

Module dimensions (mm)	250x250
Refresh frequency	3.840Hz
Module resolution	128x128px
LED drive method	dynamic
Module material	plastic (el.)
Module type	freeform
PCB type	multilayer thin film
PCB surface coating	tape film

### Panel Specifications

Panel material	steel
Panel paint	ES powder coated
Panel dimensions 'mm'	adjustable
IP level	IP40 front IP20 rear
Minimum curving diameter (mm)	850
Panel resolution	adjustable
Pixel density (pcs/sqm)	262.144
Viewing angle (horizontal x vertical)	>160° x 140°
Minimum viewing distance	>2m
Operating temperature range	0°C ~ +50°C
Storage temperature range	-20°C ~ +60°C
Operating humidity	10% ~ 90% non-condensing
Power input voltage	110 ~ 240 VAC
Power input frequency	50 ~ 60 Hz
Average power per sqm	<120W
Max power per sqm	<600W
Active PFC	YES
Load tolerance2	25% min.
Panel installation type	Fixed installation
Cooling	Passive cooling

### Other

Max input resolution	FHD, UHD, 4K, 8K
Standard video sources3	All digital formats
Brightness adjustment	Automatic & manual
Death pixel monitoring	Optional
Module monitoring	YES
Temperature monitoring	YES
Smoke monitoring	Optional
Voltage monitoring	YES
Power redundancy	N/A
Signal path backup	YES
Signal transmission	CAT or Fiber Optic
Standby scheduling	YES
Power on/off scheduling	Optional
Power saving mode	YES
Certification	CE-EMC, CE-LVD, RoHS, FCC

### Options

\*The mechanical and electronic specification options are available.

- 1- Panel dimensions can change upon customer request
- 2- That value is the remain capacity of PSU's at 100% brightness and white color content
- 3- Different types of video input available as option

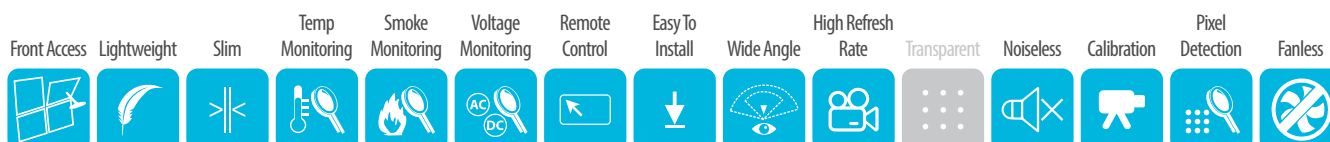

Apron Teknoloji AS. reserves the right to change any product specification, discontinue of any product or services without prior notice

TECHNICAL SPECIFICATIONS

LEDECA

# FREEFORM LDSISP02.6FF

FLEXIBLE INDOOR AND OUTDOOR LED SCREENS  
FOR CURVED AND IRREGULAR SHAPED  
PROJECTS



- Suitable for any kind of convex or concave installations
- Intelligent construction for ultra-thin frame depth
- Lightweight for easy adaptation and low cost framework design
- Improved mask structure that increases viewing angle
- Special framework design and production available

## PIAZZA MALL ISTANBUL / TURKEY



### General

Operating environment	indoor
Pixel pitch	2.6mm
Service type	front and rear access
Calibrated brightness (nits)	900nits
Lamp type	SMD
Lifespan (hours at %50 brightness)	>100.000hours
White color calibration (adj.)	3.500K~8.500K
Gray scale	>16bits
Brightness control	256 level

### Module Specifications

Module dimensions (mm)	250x250
Refresh frequency	3.840Hz
Module resolution	96x96px
LED drive method	dynamic
Module material	plastic (el.)
Module type	freeform
PCB type	multilayer thin film
PCB surface coating	tape film

### Panel Specifications

Panel material	steel
Panel paint	ES powder coated
Panel dimensions 'mm'	adjustable
IP level	IP40 front IP20 rear
Minimum curving diameter (mm)	850
Panel resolution	adjustable
Pixel density (pcs/sqm)	147.456
Viewing angle (horizontal x vertical)	>160° x 140°
Minimum viewing distance	>2.6m
Operating temperature range	0°C ~ +50°C
Storage temperature range	-20°C ~ +60°C
Operating humidity	10% ~ 90% non-condensing
Power input voltage	110 ~ 240 VAC
Power input frequency	50 ~ 60 Hz
Average power per sqm	<120W
Max power per sqm	<600W
Active PFC	YES
Load tolerance2	25% min.
Panel installation type	Fixed installation
Cooling	Passive cooling

### Other

Max input resolution	FHD, UHD, 4K, 8K
Standard video sources3	All digital formats
Brightness adjustment	Automatic & manual
Death pixel monitoring	Optional
Module monitoring	YES
Temperature monitoring	YES
Smoke monitoring	Optional
Voltage monitoring	YES
Power redundancy	N/A
Signal path backup	YES
Signal transmission	CAT or Fiber Optic
Standby scheduling	YES
Power on/off scheduling	Optional
Power saving mode	YES
Certification	CE-EMC, CE-LVD, RoHS, FCC

### Options

\*The mechanical and electronic specification options are available.

- 1- Panel dimensions can change upon customer request
- 2- That value is the remain capacity of PSU's at 100% brightness and white color content
- 3- Different types of video input available as option



Apron Teknoloji AS. reserves the right to change any product specification, discontinue of any product or services without prior notice



# FREEFORM LDSISP03.9FF

FLEXIBLE INDOOR AND OUTDOOR LED SCREENS  
FOR CURVED AND IRREGULAR SHAPED  
PROJECTS



- Suitable for any kind of convex or concave installations
- Intelligent construction for ultra-thin frame depth
- Lightweight for easy adaptation and low cost framework design
- Improved mask structure that increases viewing angle
- Special framework design and production available

**DECATHLON**  
ISTANBUL / TURKEY



## General

Operating environment	indoor
Pixel pitch	3.9mm
Service type	front and rear access
Calibrated brightness (nits)	900nits
Lamp type	SMD
Lifespan (hours at %50 brightness)	>100.000hours
White color calibration (adj.)	3.500K~8.500K
Gray scale	>16bits
Brightness control	256 level

## Module Specifications

Module dimensions (mm)	250x250
Refresh frequency	3.840Hz
Module resolution	64x64px
LED drive method	dynamic
Module material	plastic (el.)
Module type	freeform
PCB type	multilayer thin film
PCB surface coating	tape film

## Panel Specifications

Panel material	steel
Panel paint	ES powder coated
Panel dimensions' mm'	adjustable
IP level	IP40 front IP20 rear
Minimum curving diameter (mm)	850
Panel resolution	adjustable
Pixel density (pcs/sqm)	65.536
Viewing angle (horizontal x vertical)	>160° x 140°
Minimum viewing distance	>4m
Operating temperature range	0°C ~ +50°C
Storage temperature range	-20°C ~ +60°C
Operating humidity	10% ~ 90% non-condensing
Power input voltage	110 ~ 240 VAC
Power input frequency	50 ~ 60 Hz
Average power per sqm	<120W
Max power per sqm	<600W
Active PFC	YES
Load tolerance2	25% min.
Panel installation type	Fixed installation
Cooling	Passive cooling

## Other

Max input resolution	FHD, UHD, 4K, 8K
Standard video sources3	All digital formats
Brightness adjustment	Automatic & manual
Death pixel monitoring	Optional
Module monitoring	YES
Temperature monitoring	YES
Smoke monitoring	Optional
Voltage monitoring	YES
Power redundancy	N/A
Signal path backup	YES
Signal transmission	CAT or Fiber Optic
Standby scheduling	YES
Power on/off scheduling	Optional
Power saving mode	YES
Certification	CE-EMC, CE-LVD, RoHS, FCC

## Options

\*The mechanical and electronic specification options are available.

- 1- Panel dimensions can change upon customer request
- 2- That value is the remain capacity of PSU's at 100% brightness and white color content
- 3- Different types of video input available as option

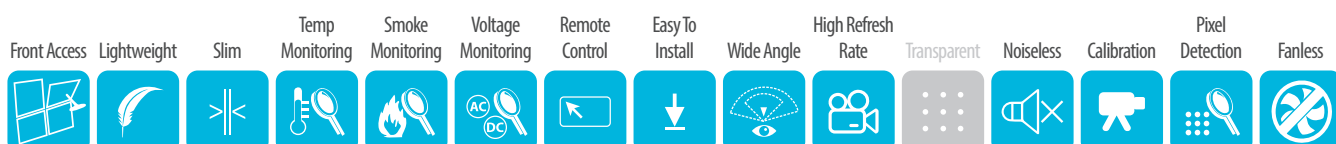

Apron Teknoloji AS. reserves the right to change any product specification, discontinue of any product or services without prior notice

TECHNICAL SPECIFICATIONS

LEDECA

# FREEFORM LDSOSP02.9FF

FLEXIBLE INDOOR AND OUTDOOR LED SCREENS  
FOR CURVED AND IRREGULAR SHAPED  
PROJECTS



- Suitable for any kind of convex or concave installations
- Intelligent construction for ultra-thin frame depth
- Lightweight for easy adaptation and low cost framework design
- Improved mask structure that increases viewing angle
- Special framework design and production available

**CARREFOURSA**  
ISTANBUL / TURKEY



## General

Operating environment	outdoor
Pixel pitch	2.9mm
Service type	front and rear access
Calibrated brightness (nits)	4,000nits
Lamp type	SMD
Lifespan (hours at %50 brightness)	>100,000hours
White color calibration (adj.)	3,500K~8,500K
Gray scale	>16bits
Brightness control	256 level

## Module Specifications

Module dimensions (mm)	250x250
Refresh frequency	3,840Hz
Module resolution	84x84px
LED drive method	dynamic
Module material	plastic (el.)
Module type	freeform
PCB type	multilayer thin film
PCB surface coating	tape film

## Panel Specifications

Panel material	steel
Panel paint	ES powder coated
Panel dimensions' mm'	adjustable
IP level	IP67 front IP65 rear
Minimum curving diameter (mm)	850
Panel resolution	adjustable
Pixel density (pcs/sqm)	112,896
Viewing angle (horizontal x vertical)	>160° x 140°
Minimum viewing distance	>3m
Operating temperature range	-10°C ~ +50°C
Storage temperature range	-20°C ~ +60°C
Operating humidity	10% ~ 90% non-condensing
Power input voltage	110 ~ 240 VAC
Power input frequency	50 ~ 60 Hz
Average power per sqm	<150W
Max power per sqm	<650W
Active PFC	YES
Load tolerance2	25% min.
Panel installation type	Fixed installation
Cooling	Passive cooling

## Other

Max input resolution	FHD, UHD, 4K, 8K
Standard video sources3	All digital formats
Brightness adjustment	Automatic & manual
Death pixel monitoring	Optional
Module monitoring	YES
Temperature monitoring	YES
Smoke monitoring	Optional
Voltage monitoring	YES
Power redundancy	N/A
Signal path backup	YES
Signal transmission	CAT or Fiber Optic
Standby scheduling	YES
Power on/off scheduling	Optional
Power saving mode	YES
Certification	CE-EMC, CE-LVD, RoHS, FCC

## Options

\*The mechanical and electronic specification options are available.

1- Panel dimensions can change upon customer request

2- That value is the remain capacity of PSU's at 100% brightness and white color content

3- Different types of video input available as option



Apron Teknoloji AS. reserves the right to change any product specification, discontinue of any product or services without prior notice

TECHNICAL SPECIFICATIONS

LEDECA



# FREEFORM LDSOSP03.9FF

FLEXIBLE INDOOR AND OUTDOOR LED SCREENS  
FOR CURVED AND IRREGULAR SHAPED  
PROJECTS



- Suitable for any kind of convex or concave installations
- Intelligent construction for ultra-thin frame depth
- Lightweight for easy adaptation and low cost framework design
- Improved mask structure that increases viewing angle
- Special framework design and production available

DEMIROREN MALL  
ISTANBUL / TURKEY



## General

Operating environment	outdoor
Pixel pitch	3.9mm
Service type	front and rear access
Calibrated brightness (nits)	5,000nits
Lamp type	SMD
Lifespan (hours at %50 brightness)	>100,000hours
White color calibration (adj.)	3,500K~8,500K
Gray scale	>16bits
Brightness control	256 level

## Module Specifications

Module dimensions (mm)	250x250
Refresh frequency	3,840Hz
Module resolution	64x64px
LED drive method	dynamic
Module material	plastic (el.)
Module type	freeform
PCB type	multilayer thin film
PCB surface coating	tape film

## Panel Specifications

Panel material	steel
Panel paint	ES powder coated
Panel dimensions' mm'	adjustable
IP level	IP67 front IP65 rear
Minimum curving diameter (mm)	850
Panel resolution	adjustable
Pixel density (pcs/sqm)	65,536
Viewing angle (horizontal x vertical)	>160° x 140°
Minimum viewing distance	>4m
Operating temperature range	-10°C ~ +50°C
Storage temperature range	-20°C ~ +60°C
Operating humidity	10% ~ 90% non-condensing
Power input voltage	110 ~ 240 VAC
Power input frequency	50 ~ 60 Hz
Average power per sqm	<150W
Max power per sqm	<650W
Active PFC	YES
Load tolerance2	25% min.
Panel installation type	Fixed installation
Cooling	Passive cooling

## Other

Max input resolution	FHD, UHD, 4K, 8K
Standard video sources3	All digital formats
Brightness adjustment	Automatic & manual
Death pixel monitoring	Optional
Module monitoring	YES
Temperature monitoring	YES
Smoke monitoring	Optional
Voltage monitoring	YES
Power redundancy	N/A
Signal path backup	YES
Signal transmission	CAT or Fiber Optic
Standby scheduling	YES
Power on/off scheduling	Optional
Power saving mode	YES
Certification	CE-EMC, CE-LVD, RoHS, FCC

## Options

\*The mechanical and electronic specification options are available.

- 1- Panel dimensions can change upon customer request
- 2- That value is the remain capacity of PSU's at 100% brightness and white color content
- 3- Different types of video input available as option

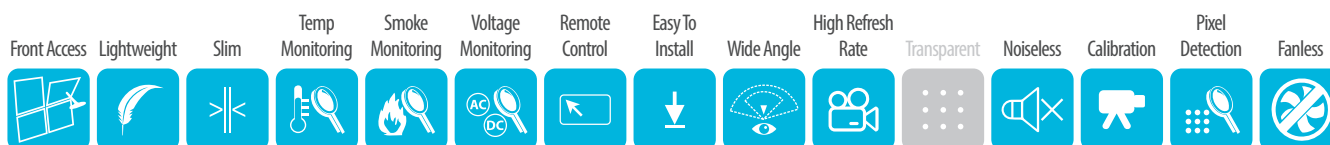

Apron Teknoloji AS. reserves the right to change any product specification, discontinue of any product or services without prior notice

TECHNICAL SPECIFICATIONS

LEDECA

# FREEFORM LDSOSP04.8FF

FLEXIBLE INDOOR AND OUTDOOR LED SCREENS  
FOR CURVED AND IRREGULAR SHAPED  
PROJECTS



- Suitable for any kind of convex or concave installations
- Intelligent construction for ultra-thin frame depth
- Lightweight for easy adaptation and low cost framework design
- Improved mask structure that increases viewing angle
- Special framework design and production available

DEMIROREN MALL  
ISTANBUL / TURKEY



## General

Operating environment	outdoor
Pixel pitch	4.8mm
Service type	front and rear access
Calibrated brightness (nits)	5.000nits
Lamp type	SMD
Lifespan (hours at %50 brightness)	>100.000hours
White color calibration (adj.)	3.500K~8.500K
Gray scale	>16bits
Brightness control	256 level

## Module Specifications

Module dimensions (mm)	250x250
Refresh frequency	3.840Hz
Module resolution	52x52px
LED drive method	dynamic
Module material	plastic (el.)
Module type	freeform
PCB type	multilayer thin film
PCB surface coating	tape film

## Panel Specifications

Panel material	steel
Panel paint	ES powder coated
Panel dimensions 'mm'	adjustable
IP level	IP67 front IP65 rear
Minimum curving diameter (mm)	850
Panel resolution	adjustable
Pixel density (pcs/sqm)	43.264
Viewing angle (horizontal x vertical)	>160° x 140°
Minimum viewing distance	>5m
Operating temperature range	-10°C ~ +50°C
Storage temperature range	-20°C ~ +60°C
Operating humidity	10% ~ 90% non-condensing
Power input voltage	110 ~ 240 VAC
Power input frequency	50 ~ 60 Hz
Average power per sqm	<150W
Max power per sqm	<650W
Active PFC	YES
Load tolerance2	25% min.
Panel installation type	Fixed installation
Cooling	Passive cooling

## Other

Max input resolution	FHD, UHD, 4K, 8K
Standard video sources3	All digital formats
Brightness adjustment	Automatic & manual
Death pixel monitoring	Optional
Module monitoring	YES
Temperature monitoring	YES
Smoke monitoring	Optional
Voltage monitoring	YES
Power redundancy	N/A
Signal path backup	YES
Signal transmission	CAT or Fiber Optic
Standby scheduling	YES
Power on/off scheduling	Optional
Power saving mode	YES
Certification	CE-EMC, CE-LVD, RoHS, FCC

## Options

\*The mechanical and electronic specification options are available.

- 1- Panel dimensions can change upon customer request
- 2- That value is the remain capacity of PSU's at 100% brightness and white color content
- 3- Different types of video input available as option

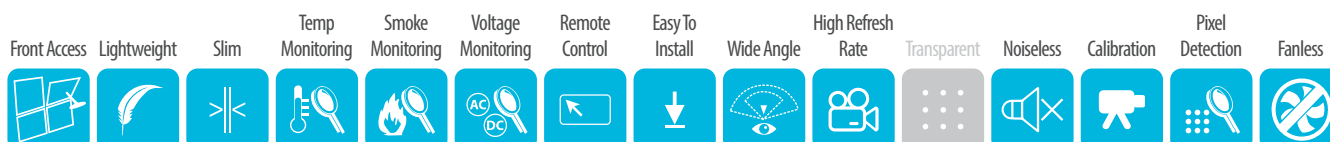

Apron Teknoloji AS. reserves the right to change any product specification, discontinue of any product or services without prior notice

TECHNICAL SPECIFICATIONS

LEDECA