

CITYLINE LDCOSP04.0CL

OUTDOOR LED SCREENS FOR DIGITAL
OUT-OF-HOME MESSAGING



- New generation cost effective led screen panel for outdoor use
- Right choice for DOOH media screen installations
- Lightweight for easy adaptation and low cost framework design
- Production level calibration for best color uniformity

CEVEP

PARIS / FRANCE



General

Operating environment	outdoor
Pixel pitch	4mm
Service type	rear access
Calibrated brightness (nits)	6.000nits
Lamp type	SMD
Lifespan (hours at %50 brightness)	> 100.000hours
White color calibration (adj.)	3.500K~8.500K
Gray scale	> 16bits
Brightness control	256 level

Module Specifications

Module dimensions (mm)	320x160
Refresh frequency	adjustable
Module resolution	80x40px
LED drive method	dynamic
Module material	plastic (PC)
Module type	apparent
PCB type	multilayer
PCB surface coating	humiseal

Panel Specifications

Panel material	galvanized steel sheet/aluminum
Panel paint	ES powder coated
Panel dimensions (mm) ¹	960x960
IP level	IP67 front, IP54 rear
Panel weight	<50kg
Panel resolution	256x256px
Pixel density (pcs/sqm)	62.500
Viewing angle (horizontal x vertical)	>120°x120°
Minimum viewing distance	>4m
Operating temperature range	-15°C ~ +45°C
Storage temperature range	-40°C ~ +60°C
Operating humidity	10% ~ 90% non-condensing
Power input voltage	110~240 VAC
Power input frequency	50~60 Hz
Average power per sqm	<150W
Max power per sqm	<650W
Active PFC	YES
Load tolerance ²	25% min.
Panel installation type	Fixed installation
Cooling	Internal fan

Other

Max input resolution	FHD, UHD, 4K, 8K
Standard video sources ³	All digital formats
Brightness adjustment	Automatic & manual
Death pixel monitoring	Optional
Module monitoring	YES
Temperature monitoring	YES
Smoke monitoring	Optional
Voltage monitoring	YES
Power redundancy	N/A
Signal path backup	YES
Signal transmission	CAT or Fiber Optic
Standby scheduling	YES
Power on/off scheduling	Optional
Power saving mode	YES
Certification	CE-EMC, CE-LVD, RoHS, FCC

Options

*The mechanical and electronic specification options are available.

- 1- Panel dimensions can change upon customer request
- 2- That value is the remain capacity of PSU's at 100% brightness and white color content
- 3- Different types of video input available as option

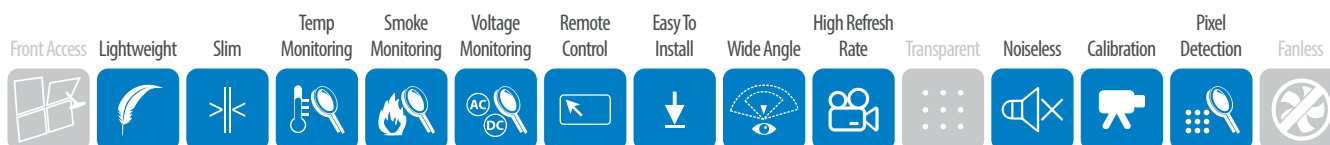

Apron Teknoloji AS. reserves the right to change any product specification, discontinue of any product or services without prior notice

TECHNICAL SPECIFICATIONS

LEDECA

CITYLINE LDCOSP05.0CL

OUTDOOR LED SCREENS FOR DIGITAL
OUT-OF-HOME MESSAGING



- New generation cost effective led screen panel for outdoor use
- Right choice for DOOH media screen installations
- Lightweight for easy adaptation and low cost framework design
- Production level calibration for best color uniformity

KADIKOY PIER BOOK CAFE
ISTANBUL / TURKEY



General

Operating environment	outdoor
Pixel pitch	5mm
Service type	rear access
Calibrated brightness (nits)	6.000nits
Lamp type	SMD
Lifespan (hours at %50 brightness)	>100.000hours
White color calibration (adj.)	3.500K~8.500K
Gray scale	>16bits
Brightness control	256 level

Module Specifications

Module dimensions (mm)	320x160
Refresh frequency	adjustable
Module resolution	64x32px
LED drive method	dynamic
Module material	plastic (PC)
Module type	apparent
PCB type	multilayer
PCB surface coating	humiseal

Panel Specifications

Panel material	galvanized steel sheet/aluminum
Panel paint	ES powder coated
Panel dimensions (mm) ¹	960x960
IP level	IP67 front, IP54 rear
Panel weight	45kg/35kg
Panel resolution	192x192px
Pixel density (pcs/sqm)	40.000
Viewing angle (horizontal x vertical)	>120°x120°
Minimum viewing distance	>5m
Operating temperature range	-15°C ~ +45°C
Storage temperature range	-40°C ~ +60°C
Operating humidity	10% ~ 90% non-condensing
Power input voltage	110~240 VAC
Power input frequency	50~60 Hz
Average power per sqm	<150W
Max power per sqm	<650W
Active PFC	YES
Load tolerance ²	25% min.
Panel installation type	Fixed installation
Cooling	Internal fan

Other

Max input resolution	FHD, UHD, 4K, 8K
Standard video sources ³	All digital formats
Brightness adjustment	Automatic & manual
Death pixel monitoring	Optional
Module monitoring	YES
Temperature monitoring	YES
Smoke monitoring	Optional
Voltage monitoring	YES
Power redundancy	N/A
Signal path backup	YES
Signal transmission	CAT or Fiber Optic
Standby scheduling	YES
Power on/off scheduling	Optional
Power saving mode	YES
Certification	CE-EMC, CE-LVD, RoHS, FCC

Options

*The mechanical and electronic specification options are available.

- 1- Panel dimensions can change upon customer request
- 2- That value is the remain capacity of PSU's at 100% brightness and white color content
- 3- Different types of video input available as option

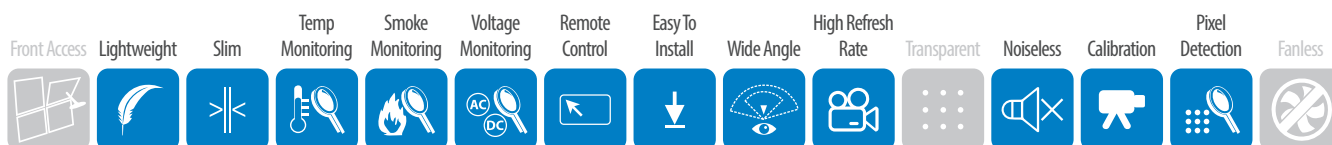

Apron Teknoloji AS. reserves the right to change any product specification, discontinue of any product or services without prior notice

TECHNICAL SPECIFICATIONS

LEDECA

CITYLINE LDCOSP06.0CL

OUTDOOR LED SCREENS FOR DIGITAL
OUT-OF-HOME MESSAGING



- New generation cost effective led screen panel for outdoor use
- Right choice for DOOH media screen installations
- Lightweight for easy adaptation and low cost framework design
- Production level calibration for best color uniformity

CEVEP

PARIS / FRANCE



General

Operating environment	outdoor
Pixel pitch	6mm
Service type	rear access
Calibrated brightness (nits)	6.000nits
Lamp type	SMD
Lifespan (hours at %50 brightness)	> 100.000hours
White color calibration (adj.)	3.500K~8.500K
Gray scale	> 16bits
Brightness control	256 level

Module Specifications

Module dimensions (mm)	320x160
Refresh frequency	adjustable
Module resolution	52x26px
LED drive method	dynamic
Module material	plastic (PC)
Module type	apparent
PCB type	multilayer
PCB surface coating	humiseal

Panel Specifications

Panel material	galvanized steel sheet/aluminum
Panel paint	ES powder coated
Panel dimensions (mm) ¹	960x960
IP level	IP67 front, IP54 rear
Panel weight	45kg/35kg
Panel resolution	156x156px
Pixel density (pcs/sqm)	26.244
Viewing angle (horizontal x vertical)	>120°x120°
Minimum viewing distance	>6m
Operating temperature range	-15°C ~ +45°C
Storage temperature range	-40°C ~ +60°C
Operating humidity	10% ~ 90% non-condensing
Power input voltage	110 ~ 240 VAC
Power input frequency	50 ~ 60 Hz
Average power per sqm	<150W
Max power per sqm	<650W
Active PFC	YES
Load tolerance ²	25% min.
Panel installation type	Fixed installation
Cooling	Internal fan

Other

Max input resolution	FHD, UHD, 4K, 8K
Standard video sources ³	All digital formats
Brightness adjustment	Automatic & manual
Death pixel monitoring	Optional
Module monitoring	YES
Temperature monitoring	YES
Smoke monitoring	Optional
Voltage monitoring	YES
Power redundancy	N/A
Signal path backup	YES
Signal transmission	CAT or Fiber Optic
Standby scheduling	YES
Power on/off scheduling	Optional
Power saving mode	YES
Certification	CE-EMC, CE-LVD, RoHS, FCC

Options

*The mechanical and electronic specification options are available.

- 1- Panel dimensions can change upon customer request
- 2- That value is the remain capacity of PSU's at 100% brightness and white color content
- 3- Different types of video input available as option

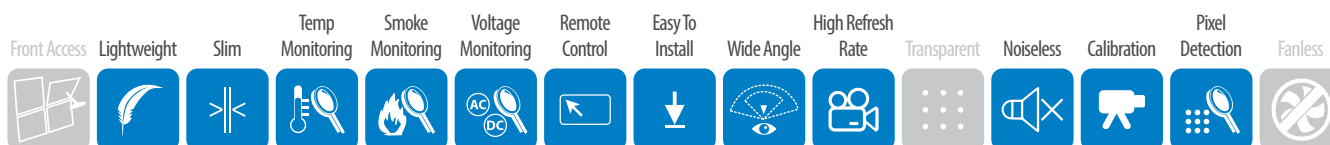

Apron Teknoloji AS. reserves the right to change any product specification, discontinue of any product or services without prior notice

TECHNICAL SPECIFICATIONS

LEDECA

CITYLINE LDCOSP06.6CL

OUTDOOR LED SCREENS FOR DIGITAL
OUT-OF-HOME MESSAGING



- New generation cost effective led screen panel for outdoor use
- Right choice for DOOH media screen installations
- Lightweight for easy adaptation and low cost framework design
- Production level calibration for best color uniformity

DIGITAL BILLBOARD ISTANBUL / TURKEY



General

Operating environment	outdoor
Pixel pitch	6.6mm
Service type	rear access
Calibrated brightness (nits)	6.000nits
Lamp type	SMD
Lifespan (hours at %50 brightness)	>100.000hours
White color calibration (adj.)	3.500K~8.500K
Gray scale	>16bits
Brightness control	256 level

Module Specifications

Module dimensions (mm)	320x160
Refresh frequency	adjustable
Module resolution	48x24px
LED drive method	dynamic
Module material	plastic (PC)
Module type	apparent
PCB type	multilayer
PCB surface coating	humiseal

Panel Specifications

Panel material	galvanized steel sheet/aluminum
Panel paint	ES powder coated
Panel dimensions (mm) ¹	960x960
IP level	IP67 front, IP54 rear
Panel weight	45kg/35kg
Panel resolution	156x156px
Pixel density (pcs/sqm)	22.500
Viewing angle (horizontal x vertical)	>120°x120°
Minimum viewing distance	>6.6m
Operating temperature range	-15°C ~ +45°C
Storage temperature range	-40°C ~ +60°C
Operating humidity	10% ~ 90% non-condensing
Power input voltage	110 ~ 240 VAC
Power input frequency	50 ~ 60 Hz
Average power per sqm	<150W
Max power per sqm	<650W
Active PFC	YES
Load tolerance ²	25% min.
Panel installation type	Fixed installation
Cooling	Internal fan

Other

Max input resolution	FHD, UHD, 4K, 8K
Standard video sources ³	All digital formats
Brightness adjustment	Automatic & manual
Death pixel monitoring	Optional
Module monitoring	YES
Temperature monitoring	YES
Smoke monitoring	Optional
Voltage monitoring	YES
Power redundancy	N/A
Signal path backup	YES
Signal transmission	CAT or Fiber Optic
Standby scheduling	YES
Power on/off scheduling	Optional
Power saving mode	YES
Certification	CE-EMC, CE-LVD, RoHS, FCC

Options

*The mechanical and electronic specification options are available.

- 1- Panel dimensions can change upon customer request
- 2- That value is the remain capacity of PSU's at 100% brightness and white color content
- 3- Different types of video input available as option

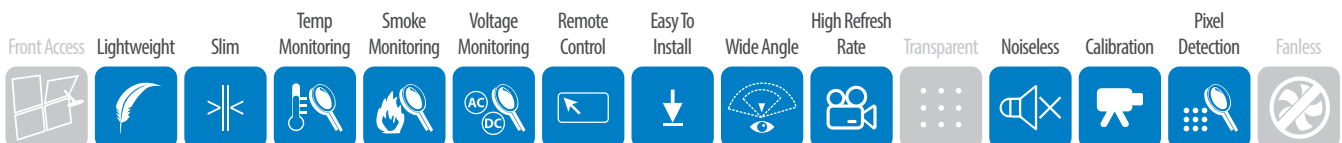

Apron Teknoloji AS. reserves the right to change any product specification, discontinue of any product or services without prior notice

TECHNICAL SPECIFICATIONS

LEDECA

CITYLINE LDCOSP08.0CL

OUTDOOR LED SCREENS FOR DIGITAL
OUT-OF-HOME MESSAGING



- New generation cost effective led screen panel for outdoor use
- Right choice for DOOH media screen installations
- Lightweight for easy adaptation and low cost framework design
- Production level calibration for best color uniformity

MALL OF ISTANBUL
ISTANBUL / TURKEY



General

Operating environment	outdoor
Pixel pitch	8mm
Service type	rear access
Calibrated brightness (nits)	7,000nits
Lamp type	SMD
Lifespan (hours at %50 brightness)	>100,000hours
White color calibration (adj.)	3,500K~8,500K
Gray scale	>16bits
Brightness control	256 level

Module Specifications

Module dimensions (mm)	320x160
Refresh frequency	adjustable
Module resolution	40x20px
LED drive method	dynamic
Module material	plastic (PC)
Module type	apparent
PCB type	multilayer
PCB surface coating	humiseal

Panel Specifications

Panel material	galvanized steel sheet/alu- minum
Panel paint	ES powder coated
Panel dimensions (mm) ¹	960x960
IP level	IP67 front, IP54 rear
Panel weight	45kg/35kg
Panel resolution	128x128px
Pixel density (pcs/sqm)	15,625
Viewing angle (horizontal x vertical)	>120°x120°
Minimum viewing distance	>8m
Operating temperature range	-15°C ~ +45°C
Storage temperature range	-40°C ~ +60°C
Operating humidity	10% ~ 90% non-condensing
Power input voltage	110~240 VAC
Power input frequency	50~60 Hz
Average power per sqm	<150W
Max power per sqm	<650W
Active PFC	YES
Load tolerance ²	25% min.
Panel installation type	Fixed installation
Cooling	Internal fan

Other

Max input resolution	FHD, UHD, 4K, 8K
Standard video sources ³	All digital formats
Brightness adjustment	Automatic & manual
Death pixel monitoring	Optional
Module monitoring	YES
Temperature monitoring	YES
Smoke monitoring	Optional
Voltage monitoring	YES
Power redundancy	N/A
Signal path backup	YES
Signal transmission	CAT or Fiber Optic
Standby scheduling	YES
Power on/off scheduling	Optional
Power saving mode	YES
Certification	CE-EMC, CE-LVD, RoHS, FCC

Options

*The mechanical and electronic specification options are available.

- 1- Panel dimensions can change upon customer request
- 2- That value is the remain capacity of PSU's at 100% brightness and white color content
- 3- Different types of video input available as option

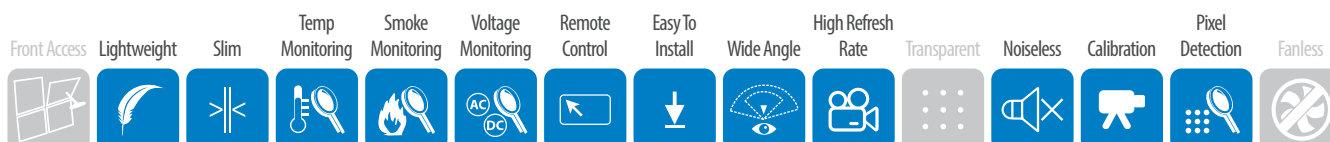

Apron Teknoloji AS. reserves the right to change any product specification, discontinue of any product or services without prior notice

TECHNICAL SPECIFICATIONS

LEDECA

CITYLINE LDCOSP10.0CL

OUTDOOR LED SCREENS FOR DIGITAL
OUT-OF-HOME MESSAGING



- New generation cost effective led screen panel for outdoor use
- Right choice for DOOH media screen installations
- Lightweight for easy adaptation and low cost framework design
- Production level calibration for best color uniformity

MASKO

ISTANBUL / TURKEY



General

Operating environment	outdoor
Pixel pitch	10mm
Service type	rear access
Calibrated brightness (nits)	6500nits
Lamp type	SMD
Lifespan (hours at %50 brightness)	>100.000hours
White color calibration (adj.)	3.500K~8.500K
Gray scale	>16bits
Brightness control	256 level

Module Specifications

Module dimensions (mm)	320x160
Refresh frequency	adjustable
Module resolution	32x16px
LED drive method	dynamic
Module material	plastic (PC)
Module type	apparent
PCB type	multilayer
PCB surface coating	humiseal

Panel Specifications

Panel material	galvanized steel sheet/alu- minum
Panel paint	ES powder coated
Panel dimensions (mm) ¹	960x960
IP level	IP67 front, IP54 rear
Panel weight	45kg/35kg
Panel resolution	96x96px
Pixel density (pcs/sqm)	10.000
Viewing angle (horizontal x vertical)	>120°x120°
Minimum viewing distance	>10m
Operating temperature range	-15°C ~ +45°C
Storage temperature range	-40°C ~ +60°C
Operating humidity	10% ~ 90% non-condensing
Power input voltage	110~240 VAC
Power input frequency	50~60 Hz
Average power per sqm	<150W
Max power per sqm	<650W
Active PFC	YES
Load tolerance ²	25% min.
Panel installation type	Fixed installation
Cooling	Internal fan

Other

Max input resolution	FHD, UHD, 4K, 8K
Standard video sources ³	All digital formats
Brightness adjustment	Automatic & manual
Death pixel monitoring	Optional
Module monitoring	YES
Temperature monitoring	YES
Smoke monitoring	Optional
Voltage monitoring	YES
Power redundancy	N/A
Signal path backup	YES
Signal transmission	CAT or Fiber Optic
Standby scheduling	YES
Power on/off scheduling	Optional
Power saving mode	YES
Certification	CE-EMC, CE-LVD, RoHS, FCC

Options

*The mechanical and electronic specification options are available.

- 1- Panel dimensions can change upon customer request
- 2- That value is the remain capacity of PSU's at 100% brightness and white color content
- 3- Different types of video input available as option

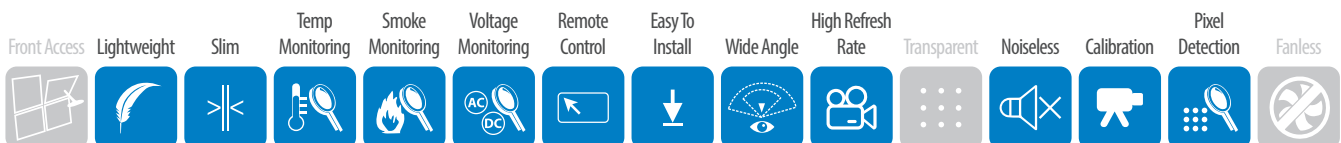

Apron Teknoloji AS. reserves the right to change any product specification, discontinue of any product or services without prior notice

TECHNICAL SPECIFICATIONS

LEDECA